

CONSIS.B

FAMA

Maximising efficiency with solutions as individual as your pharmacy.

Complete pharmacy storage and dispensing systems.



Willach

Pharmacy Solutions

Company Introduction

- 2 About Willach
- 4 Complete solutions and customer care
- 5 The Willach approach

Design and Workflow

- 6 Efficient and effective workflow design
- 8 Conceptual visualisation

Product Range Introduction

- 10 Modular systems. Bespoke solutions.
- 11 Specialised systems for specialised needs

FAMA® Product Range

- 13 Medication management at your fingertips
- 14 The right elements for every work area. Ergonomics and safety thought out in detail
- 16 Flexibility with FAMA®—complete storage and workspace organisation
- 18 FAMA® shelving systems
- 24 FAMA® drawer systems
- 32 FAMA® components

CONSYS® Product Range

- 35 Fast. Compact. Efficient.
- 36 Maximise the benefits from the key pharmacy resources: staff, stock & space.
- 37 A range of options for individual needs
- 38 CONSYS® the Australian pharmacists’ choice in automation

Case Studies

Innovators since 1889



Willach Australia Office, Showroom and Warehouse in Burwood, Victoria.

Willach is a family owned business that is proud of a company culture of innovation and tradition that spans 4 generations and more than 125 years of history.

For many decades Willach has been setting industry standards and today the company is a premier provider of pharmacy solutions to more than 30 countries worldwide.

Willach undertakes all product development, engineering and production in Germany to guarantee the highest level of quality and precision in line with highest international accepted quality standards (ISO 9001).



Willach Group HQ and factory in Ruppichteroth near Cologne, Germany.

Our customers include small, medium and large-sized community and hospital pharmacies.

With a broad, modular product portfolio and a highly skilled team of consultants and designers we are able to customise a solution that reflects your vision and best suits your business requirements.

The flexibility of our systems has allowed us to dramatically improve the workflow and operating efficiencies of your dispensary regardless of size, shape or budget.

Australian market leaders since 2004



Willach Warehouse, Burwood, Victoria

A wholly owned division of the Willach Group, Willach Pharmacy Solutions is Australia's market leader in dispensary storage systems and efficient workflow design. We invest heavily into our national team of locally based consulting pharmacists, designers and technicians—providing unrivalled local market knowledge and understanding allowing us to deliver exceptional customer care and support.

As experts in the field of dispensary solutions we appreciate that each pharmacy business is unique and one



Willach Showroom and Training Facility, Burwood, Victoria

size does not fit all. Together, we will liaise with all relevant stakeholders to work towards a dispensary design that solves your challenges and meets your business objectives.

Our team of professionals will guide you through a comprehensive analysis of your dispensary layout, stock and staff resources as well as workspace and storage requirements. The result is a custom design that provides operational efficiency as well as improved quality and cost outcomes.

Complete solutions and customer care.



At Willach we pride ourselves on exceptional customer service from initial consultation to ongoing support.



Consulting

We take a holistic approach to planning every aspect of your pharmacy dispensary. We'll spend time with you to analyse your existing workflows, customer needs and space availability, to establish the best opportunities for increased efficiency and profit. We can also recommend expert finance and leasing partners as well as leading industry business analysts to assist with funding and additional business benchmarking services.

Site planning and design

Our qualified in house spatial designers will work with our consultants and the project team to design and draft a floor plan to suit the specific requirements of your pharmacy. This complimentary service provides the opportunity to view the proposed concepts as both 2D and 3D drawings to gain a better understanding of the options.

Implementation support

Once a design concept has been accepted and approved, the team at Willach continue to work closely with you to ensure correct installation of Willach components. We provide assistance and guidance to staff to ensure appropriate set-up and use of the specialised equipment. All our robotic CONSIG[®] solutions are fully installed by our technical team and include comprehensive pre-installation training. In addition, a Willach trainer is onsite for GoLive to provide support, answer questions and ensure a smooth first day of operation. In addition, to maximise the benefits of our system, we offer a structured refresher training program for all existing customers.

Customer Care

As part of our commitment to you, our team is always happy to answer queries and provide ongoing advice. With a local warehouse backed by a highly responsive support team you can rest assured you are in good hands.

Our CONSIG[®] customers can also benefit from a 1800 94 55 22 Service Line operated by our staff 7 days a week — with locally based service points in VIC, SA, WA, NSW and QLD providing you peace of mind. In addition, customers can easily order all spare parts, accessories and dispensary consumables via the Willach Online Shop at shop.willach.com.au.

Efficient and Effective Workflow Design.

Operational efficiency is all about having the right resource in the right place at the right time—and in the right quantity.

A pharmacy dispensary is a unique and highly specialised work environment that is home to a variety of tasks and processes. This requires a layout and systems that are functional and practical, addressing the common issues faced by staff; insufficient storage space, poor inventory management, cramped work spaces, clutter and stressed staff – issues that basic shelving and simple design often fall short of addressing.

Designing such a work environment therefore requires specific expertise, knowledge and understanding—a unique skill set Willach is proud to have in their team of experienced pharmacists and qualified spatial designers.

At Willach, our design philosophy considers the overall logistics of the pharmacy to identify where your key assets will contribute the most value to your operation—improving quality whilst controlling costs.

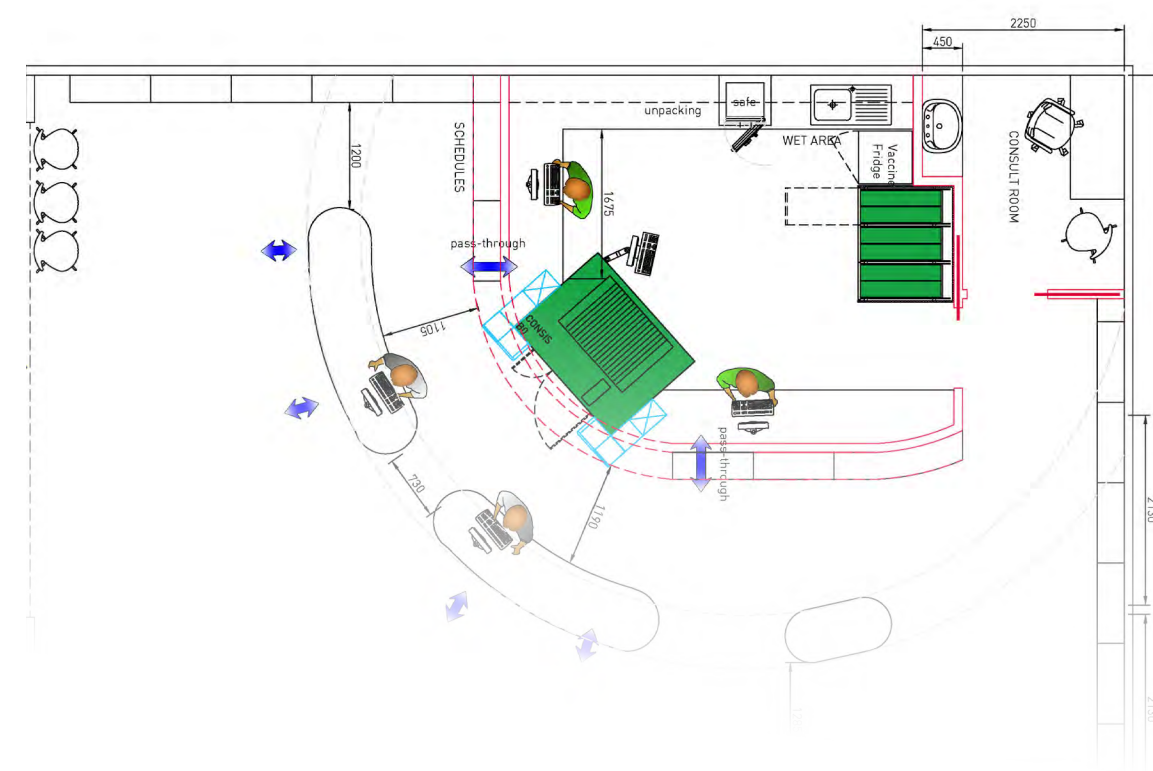

Professional workspace and workflow design examines your resources, their most valuable functions and aligns them through a design that creates the optimal work environment with all the necessary stock and resources at your fingertips. The result creates space and maximises output whilst reducing errors and minimising waste—operational efficiency and effectiveness.

Our expert team is able to present a design proposal of your pharmacy, with detailed floor plans as well as 2D and 3D concept drawings to support your business case and fulfill the Pharmacy Board Authority requirements.



Conceptual Visualisation

Each project is analysed and conceptualised as a floor plan and a three dimensional rendering by our spatial designers. The concept is then revised until the optimum solution and layout have been agreed upon.

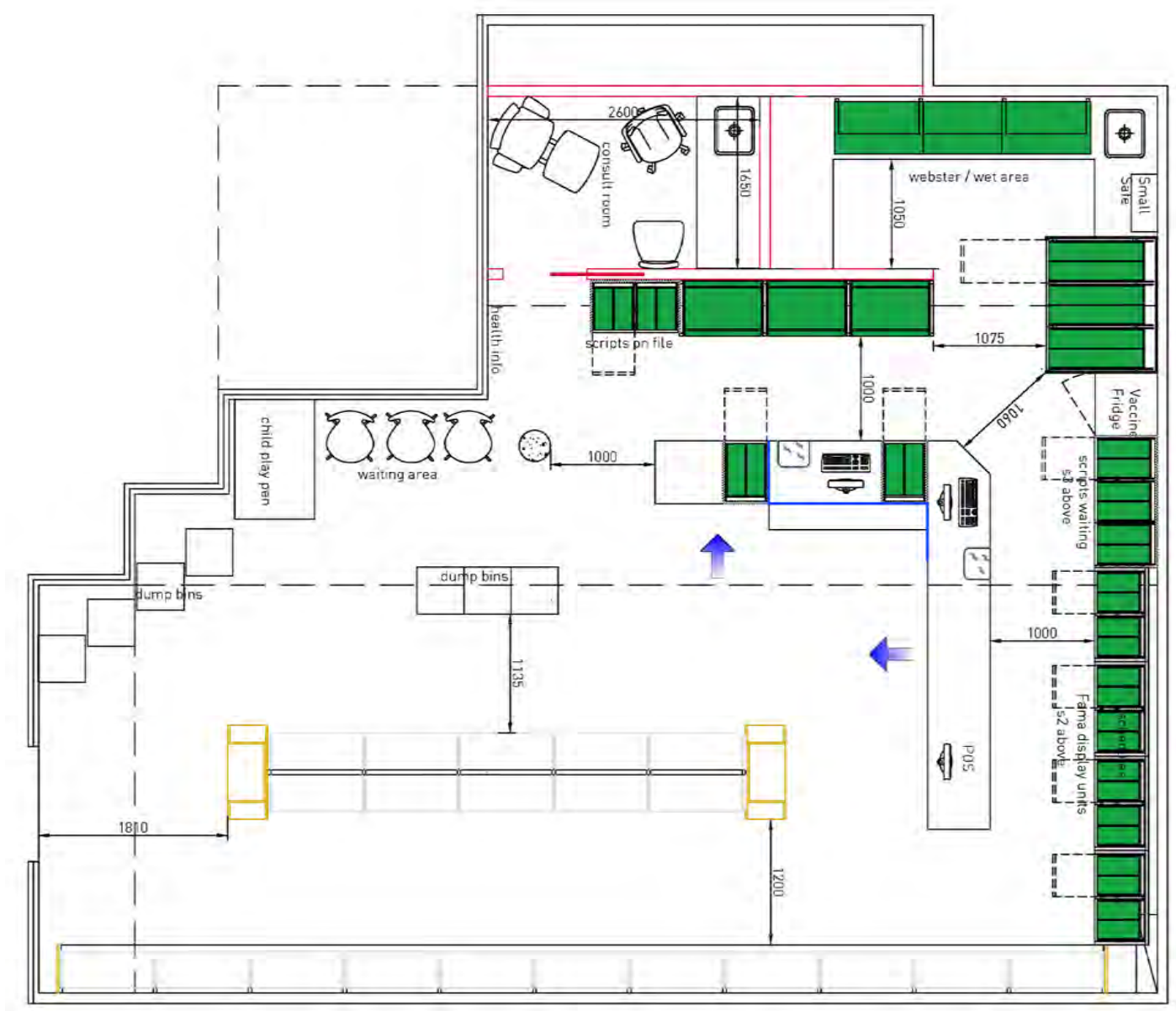
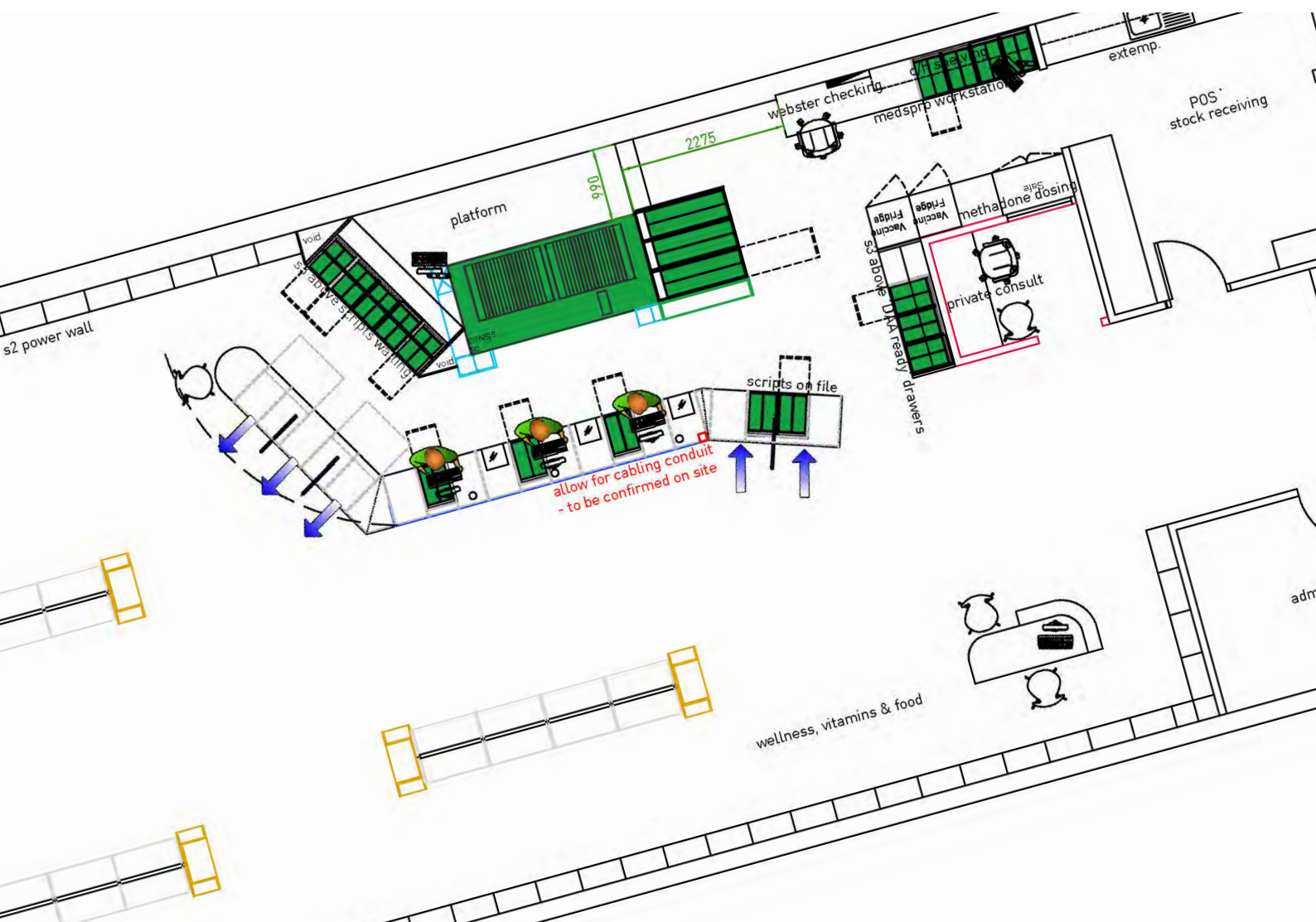

Modular systems. Bespoke solutions.

Willach is one of the leading manufacturers worldwide of tailor-made solutions specifically engineered for storage of healthcare products.



Developed to meet the unique storage and workflow requirements of the pharmacy environment, our broad product portfolio includes specialised drawer and shelving systems as well as automated dispensing robots. With flexibility in mind, our modular storage systems have been designed to provide endless configuration possibilities – adaptability to suit any size, space and budget.

Specialised systems for specialised needs.

Specialised storage systems are integral to streamlining work processes and maximising operational efficiency. In a demanding and complex work environment, where space is limited, your time is highly valuable and budgets are often under pressure, Willach's smart storage systems:

- Create space
- Save time
- Optimise efficiency
- Reduce errors
- Improve stock management
- Maximise returns

The FAMA® system provides a range of drawers and shelving options for all your storage requirements. Custom configuration produces the optimal dispensary layout, ensuring products are stored compactly, highly organised and at your fingertips, saving you valuable time and a large amount of space.

The CONSYS® robotic systems are Willach's state of the art automated dispensing solutions. Providing fast and accurate dispensing as well as simple and efficient stock management, CONSYS® is the ideal storage system for high volume dispensing on a very compact footprint.



Medication Management at your fingertips

Ultimate quality and total precision make FAMA® the leading storage system for pharmacies. The range of drawer and shelving options is highly flexible and modular with design details catering to the unique storage requirements of the pharmacy environment.



The right elements for every work area.



FAMA® sloping trays: these trays are designed to provide compact and neat storage for either high turnover stock in FAMA® fast mover units or convenient access to stock above a work bench in the FAMA® worktop units. Stock is picked from the front and when required, trays easily slide out for refilling from the back. Adjustable dividers keep stock organised and enable fast and accurate product selection.



FAMA® flat trays: similarly to sloping trays, these provide storage for a variety of items and quantities. Dividers and sub-dividers separate stock and the drawers can be positioned at any height within the metal frames, making them ideal for both small and bulky package storage. The flat trays also extend out for stock replenishment ensuring easy stock rotation.



FAMA® flat shelves: integrated either at the base of FAMA® fast mover units, below a work bench or above a work bench, they are ideal for storing bulky items, excess stock or folders and reference books—customised to suit the individual needs of each work area.



FAMA® round shelf: the round shelf systems provide a unique storage option for key high volume items and are ideal for a work area with multiple users requiring quick and easy access to these key products. Adjustable dividers and label holders ensure stock is organised and product replenishment and selection made simple and accurate.



FAMA® drawers: available in full height or under bench options and a variety of configurations the FAMA® drawers provide storage for standard medicine packages and bottles, as well as consumables, DAA, scripts on file and miscellaneous items.



FAMA® drawers: Single height or double height drawer depth adds further flexibility in storage options. FAMA® drawer systems ensure products are hygienically stored free from dust, whilst the divider and labelling accessories keep everything clearly sorted.

Ergonomics and safety thought out in detail.



Safety hooks and springs: the safety hook (patent pending) increases the safety and longevity of the sloping trays and ensures they won't fall out. The spring mechanism keeps the tray's movement slow, smooth and controlled and means less effort is required to use even a heavily stocked tray.



Easy touch release: the specialised mechanism ensures simple and safe opening of sloping trays. Light pressure releases the tray to slide out. When the tray is pushed back in, the mechanism safely locks the tray back in position.



Tray dividers: durable powder coated steel dividers keep items organised and clearly separated. The position of dividers is fully adjustable to suit various package sizes and can be easily repositioned as required.



Drawer dividers and subdividers: a variety of dividers and subdividers are supplied with drawer units. These are fully adjustable and can be used to create compartments and sub-compartments for highly organised storage—meaning product selection is fast, simple and most importantly accurate.



Labelling strip: a transparent strip on each tray allows for clear labelling of contents without obstructing product visibility. Labels can include barcodes which can easily be scanned through the transparent strip.



Drawer labels: individual label holders can be clipped on to the side of the drawer units or on to the plastic cross dividers within the drawer, allowing for clear labelling of all products.



FAMA® acrylic boxes: a flexible component of the worktop units, the acrylic boxes keep bench tops clutter free by storing everyday items, consumables and miscellaneous accessories above the bench but within easy reach.



Carriage step: full height FAMA®.K drawers have an integrated slide out carriage step allowing easy access to higher drawers without the need for less stable stepladders or stools. The self-retracting mechanism of the step means it simply rolls back in once you step off.



FAMA® accessories: additional options and accessories such as locks, stationary drawers, filing trays, spatula and mortar trays are available to further customise the configuration depending on the work area requirements.

Flexibility with FAMA® — complete storage and workspace organisation.



FAMA® sloping tray: organised storage and clear product selection with adjustable dividers and refilling made easy with the simple slide out mechanism.



FAMA® flat tray: horizontal trays with pull out mechanism and adjustable dividers, keep products organised and easily accessible.



FAMA® drawer: available in a variety of configurations and made even more flexible with dividers and subdividers, drawers provide a highly compact and organised storage option for a diverse range of products and consumables—with the added benefit of a closed system keeping contents free from dust.



FAMA® flat shelves: sturdy fixed flat shelves can be integrated below or above the work-bench providing storage for excess stock or space for reference books, folders etc.



FAMA® top light: the optional top light can provide additional directed lighting for the upper shelf area.



FAMA® worktop light: effectively integrated lighting creates perfect working conditions with clear work surface visibility.



FAMA® acrylic boxes: hooking onto the worktop rail, the acrylic boxes can be angled or hooked horizontally and slide along the rail to any required position. Single or multiple rows can be configured for organised above bench storage to keep work benches clutter free.



FAMA® utility tray: a flat sturdy steel tray with smooth finish that can be pulled out for additional workspace or for storing keyboards, printers or PC units.

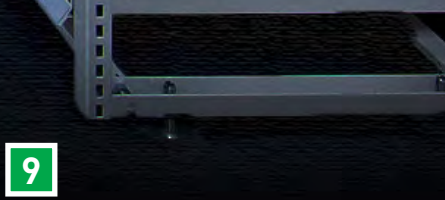

FAMA® corner shelf: the corner shelf allows for the best use of space available, linking modules around a corner with a continuous work bench and providing functional storage in a normally underutilised corner area.





FAMA
fast mover 300

FAMA® shelving systems

The FAMA® shelving system is a high quality, durable product, offering a great long-term investment. All components including frames, flat shelves, drawers, trays and dividers are made of high quality powder coated steel guaranteeing longevity.

Developed and engineered specifically for the pharmacy work environment, the shelves are designed to maximise your storage space, improve stock management and optimise productivity.

The flexible and modular components of FAMA® provide endless configuration options, allowing the system to be easily retrofitted into existing dispensaries, integrated into new projects as well as extended with future growth. If the workspace requirements change or a work area is moved, the flexibility and durability of FAMA® allows for easy change; shelf positions can easily be adjusted and components interchanged as required.

Configuration Options

FAMA® fast mover 300



flat shelf 300
8 x sloping tray 300
flat shelf 300
5 x flat shelf 300

FAMA® fast mover 500



rooftop shelf 500
8 x sloping tray 500
2 x flat shelf 500
rooftop shelf 500
5 x flat shelf 500
(back-to-back)
2 x rooftop shelf 500
16 x sloping tray 500
4 x flat shelf 500

The FAMA® fast mover 300 and 500 can comprise of up to 10 pull out sloping trays, non-pull out flat shelves or a combination of the two as well as additional pull out horizontal tray options in the shelving system 500 units. Shelves can be moved into any position within the frame to cater for various height requirements. Adjustable steel dividers may be used to separate products on sloping shelves whilst there are two options for non-pull out flat shelves: divider compatible - ideal for small product storage or a non-divider compatible basic finish – ideal for bulky item storage.

FAMA
fast mover 500

FAMA® fast mover 300

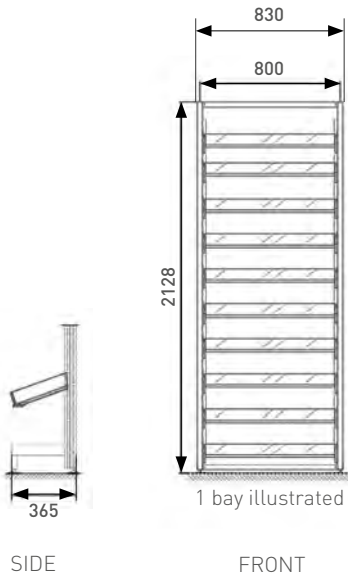

1 bay of FAMA® fast mover 300	
Standard configuration:	10 pull-out sloping shelves
Storage capacity:	100 lines for up to 800 packages
Unit depth:	365 mm
Overall width x height:	830 x 2128 mm (including 30 mm steel frame)

Note: Cladding is supplied by others unless agreed otherwise.

FAMA® fast mover 500

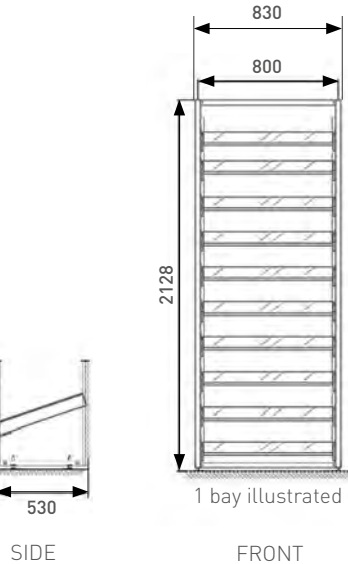

1 bay of FAMA® fast mover 500	
Standard configuration:	10 pull-out sloping shelves
Storage capacity:	100 lines for up to 1300 packages
Unit depth:	530 mm
Overall width x height:	830 x 2128 mm (including 30 mm steel frame)

Note: Cladding is supplied by others unless agreed otherwise.

Configuration Options

FAMA® shelving system 600



FRONT BACK

- 1 x rooftop shelf 600
- 5 x sloping shelf 600
- 2 x flat shelf 600

The FAMA® shelving system 600 has been developed especially with the specific requirements of hospital pharmacies, medical centres or bulk storage areas in mind. Shelves can be positioned at any height within the frame and are available as either sloping or horizontal fixed shelves. Compatible for use with steel dividers the units can also be supplied with a variety of tubs dependent on individual storage requirements.

FAMA® worktop system



(back-to-back)
worktop
20 x flat tray 500

(back-to-back)
worktop light
box rail
16 x acrylic box
worktop
16 x drawer 500 (single height)
4 x drawer 500 (double height)

flat shelf 300
4 x sloping tray 300
worktop light
box rail
4 x acrylic box
worktop
4 x drawer 500 (single height)
1 x drawer 500 (double height)

3x flat shelf 300
worktop light
box rail
4 x acrylic box
worktop
5 x flat tray 500

The FAMA® worktop system is a multipurpose unit offering one of the broadest configuration options. Suitable for individual work stations or as a multifunctional storage and work-space setup the varying components offer a high degree of flexibility, catering to a wide range of work and preparation environments. Fixed or pull out shelves and trays along with a range of dividers, sub-dividers, acrylic tubs and integrated light ensure an organised and efficient workspace.



FAMA® shelving system 600



1 bay of FAMA® shelving system 600	
Standard configuration:	1 top shelf 600 5 sloping shelves 600 2 flat shelves 600
Storage capacity:	Depends on configuration and use
Unit depth:	590 mm
Overall width x height:	1310 x 2128 mm (including 30 mm steel frame)

Note: Cladding is supplied by others unless agreed otherwise.



FAMA worktop system

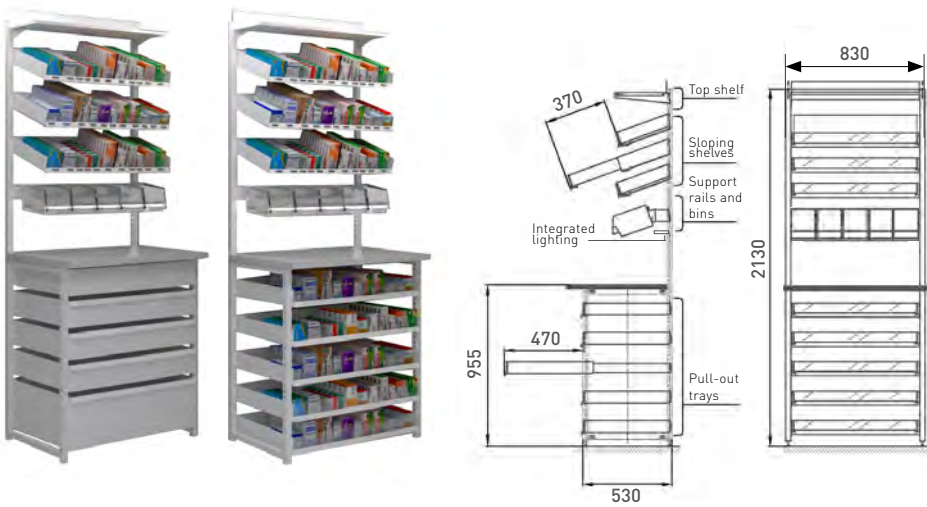

1 bay of FAMA® worktop system	
Standard configuration:	1 top shelf 3 sloping shelves 5 pull-out drawers/trays Support rails and 5 plastic bins
Storage capacity:	Depends on configuration and use
Unit depth:	530 mm (+70 mm including recommended bench depth of 600 mm)
Overall width x height:	830 x 2130 mm (including 30 mm steel frame)

Note: Benchtop is supplied by others unless agreed otherwise.



FAMA® round shelf

The FAMA® round shelf provides a compact storage option ideally suited for frequently dispensed items. The unique design of the rotating round shelves allow for fast and direct access to stock from any angle meaning multiple surrounding workstations can all be within reach of the most frequently used stock saving valuable time.

Stock is arranged on shelves using movable steel dividers, with individual label holders making product identification and reordering simple, fast and accurate. A patented magnetic mechanism partitions each segment and enables easy filling of stock to the rear of each shelf, allowing for easy stock rotation.



360° access to products with rotating shelves enables efficient picking or filling.



Individual label holders are supplied to enable clear product identification.



Single handed operation of magnetic mechanism for partitioning segments allowing access to the rear.



Stock rotation made easy by picking from the front and filling to the rear.

FAMA
round shelf 1800

FAMA® round shelf 1800

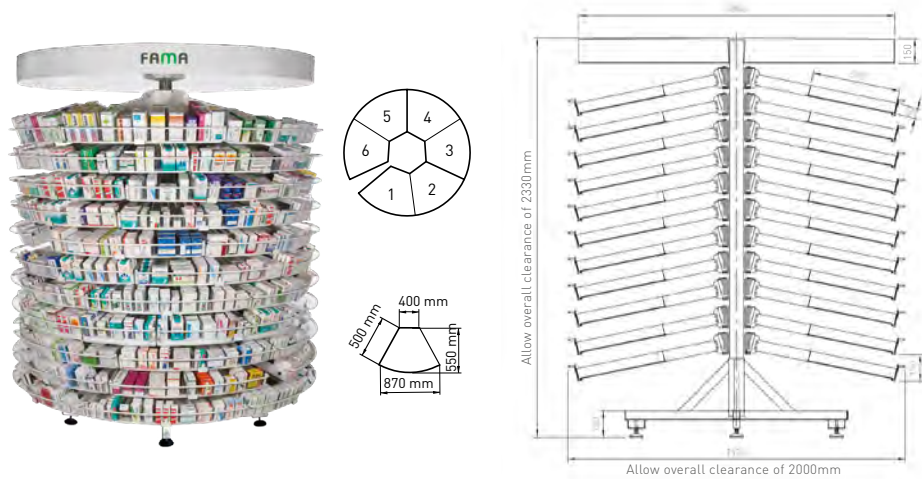

1 unit of FAMA® round shelf 1800

Standard configuration:	11 sloping shelves 6 segments on each shelf Magnetic connectors for segments
Storage capacity:	Up to 500 lines with up to 6,000 packages Up to 60 lm / 13 m ² Footprint of 2.9 m ²
Depth of shelves:	500 mm
Overall width x height:	1922 x 2330 mm

FAMA
round shelf 1200

FAMA® round shelf 1200

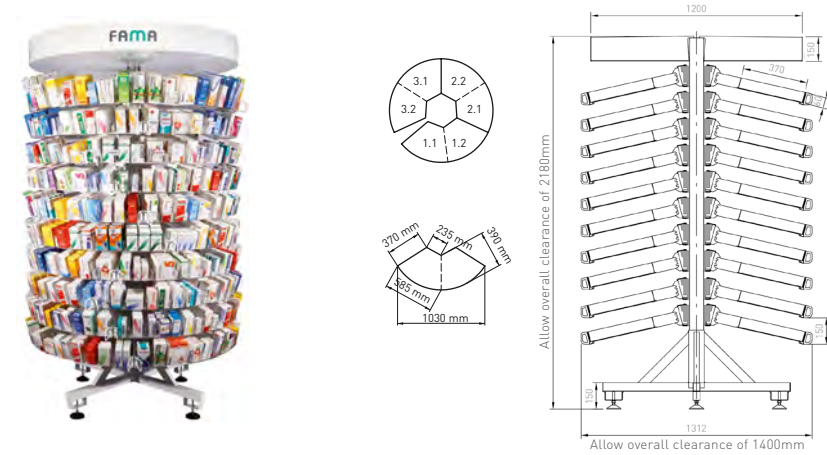

1 unit of FAMA® round shelf 1200

Standard configuration:	10 sloping shelves 6 segments on each shelf Magnetic connectors for segments
Storage capacity:	Up to 300 lines with up to 3,000 packages Up to 40 lm / 6 m ² Footprint of 1.4 m ²
Depth of shelves:	370 mm
Overall width x height:	1312 x 2180 mm



FAMA® drawer systems

FAMA® drawers are Europe’s leading pharmacy drawer system. No other drawer system offers the compact storage capacity and perfect organisation that the patented technology of the FAMA® drawers delivers. Constructed from powder coated steel, the durability of the drawers provides unequivocal longevity and return on investment.

All drawers are made with wire mesh bases that keep contents clean and eliminate dust collection as well as allowing for easy visibility of items in overhead drawers. A self-closing mechanism is standard in all of the drawers and enhances the ergonomics and convenience of the units.

Available as high capacity full height FAMA®.K, FAMA®.DAA or versatile FAMA®.M comfort, the drawer systems provide the ultimate compact storage solution when space is limited.



Products are stored in a highly organised manner with the aid of various dividers and sub-dividers. This greatly improves efficiency and accuracy for both product selection and stock management.



High capacity storage and a variety of drawer size options provides numerous applications and uses in addition to medication packages such as stationery accessories, storing scripts on file or scripts ready.

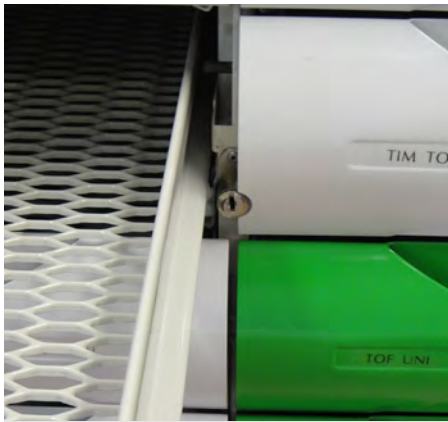

An optional locking system can be fitted where stored items require restricted access. The mechanism provides the option for locking individual, multiple or all drawers in the unit and can be easily adjusted by the user.

FAMA®.K large-capacity drawers

Available drawer sizes

3 bay illustrated

1 bay of FAMA®.K large-capacity drawers	
Standard configuration:	13 single height drawers (125 mm high x 417 mm wide) 1 double height drawer (250 mm high x 417 mm wide) 1 carriage step
Storage capacity:	Up to 400 SKU's Up to 2000 packs/bay
Drawer unit depth:	1070 mm (K1000); 1270 mm (K1200)
Overall width x height:	1303 x 2041 mm (including 16 mm cladding; width is based on 3 bays)

Note: Cladding is supplied by others unless agreed otherwise.

The FAMA®.K drawers are one of the most compact storage solutions; with one FAMA®.K 1200 unit providing 30 linear metres of storage on a 0.5m² footprint. Drawers are available in single and double height options with a fixed central divider, movable cross dividers and subdividers or can be configured without dividers if required.

A key feature of the FAMA®.K is the integrated carriage step which enables easy access to top drawers and has a self-return mechanism for safety and convenience.



FAMA®.K provides highest capacity storage with each drawer using half the height of regular finger shelves. A single bay drawer unit consists of up to 15 single drawers, or a combination of single and double height drawers.



An integrated carriage step in each unit of FAMA®.K enables easy access to top drawers. The unique engineering of the step means it locks safely in place when pulled out, can hold up to 150kg and self-returns once the user steps off.



A variety of dividers, subdividers, label holders, custom coloured drawer fronts and accessories make the FAMA®.K system a highly organised storage solution maximising space, increasing efficiency and improving accuracy.

FAMA®.M comfort drawers

The FAMA®.M comfort drawers include Willach's latest engineering and design, combining functional flexibility with ergonomic features such as easy pull opening mechanism, auto close with soft stop mechanism and a fully open lock system—allowing the drawer to remain open when fully extended.

The versatility of the FAMA®.M comfort drawers allows them to be utilised in various work environments such as underbench workstation drawers, multiple unit underbench storage or built up to custom heights to maximise capacity on a minimal footprint.

FAMA®.M comfort drawers are available in 2 depths; 450mm and 550mm as well as a combination of 3 widths and 2 height options with various configuration combinations possible. A variety of cross dividers, sub-dividers, label holders, an optional stationary drawer and other accessories complete the highly efficient time and space saving benefits of this system.



Easy Pull: the patent-pending design creates less tension requiring far less effort to open drawers allowing for fast and easy access to stock.



Comfort Store: a built in ergonomic feature keeps fully extended drawers open, meaning both hands can be free when accessing the drawer for picking or replenishment.



Auto Close: the self-closing mechanism automatically closes drawers that are not fully extended, requiring less effort and time as they can be left to close after use.



Soft Stop: the soft stop feature slows the drawer down at the end of the self-closing motion, preventing rebound and stock disruption with added safety and convenience.



FAMA®.M comfort drawers

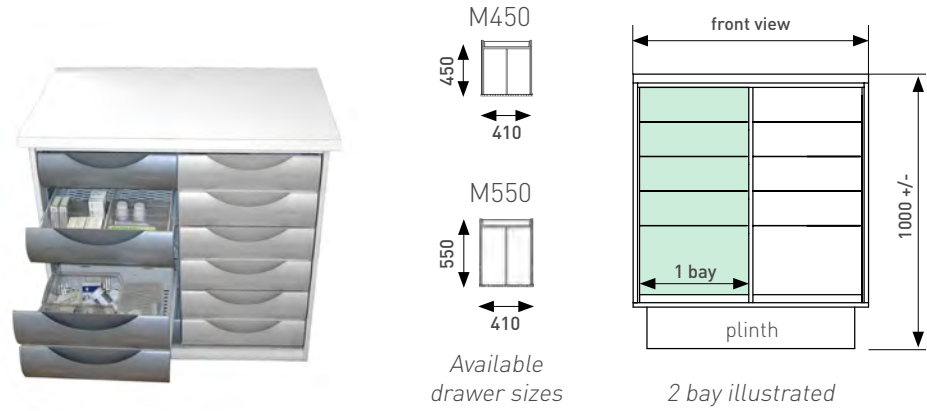

1 bay of FAMA®.M comfort under bench drawers	
Standard configuration:	4 single height drawers (125 mm) 1 double height drawer (250 mm)
Storage capacity:	Depends on drawer configuration and use
Drawer unit depth:	600 mm (M550); 500 mm (M450)
Overall width x height:	442 x 811 mm (including 16 mm cladding, no plinth)

Note: Cladding is supplied by others unless agreed otherwise.

Configuration Options



FAMA®.M comfort: standard steel drawer front and one removable central steel divider.



FAMA®.M3 comfort: requires custom wood or laminate drawer front and has one fixed and one removable steel divider.



FAMA®.M4 comfort: requires custom wood or laminate drawer front and has one central fixed divider and two adjacent removable steel dividers.



FAMA®.M comfort double height: all drawer configurations are also available in a double height option.

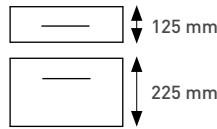
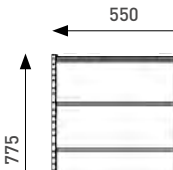
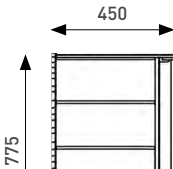
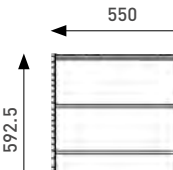
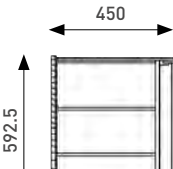
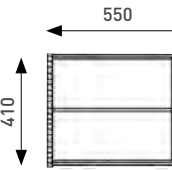
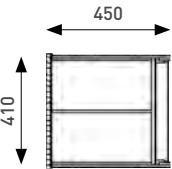

Application examples of the FAMA.M comfort drawers



Direct Dispense Stations

Perfectly suited to direct dispensing work stations. One bay of FAMA.M drawers provides ideal storage for stationary, ultra-fast moving medicines as well as S2 and S3 products – all within convenient and easy reach.



Traditional Dispense Stations

Traditional Dispense Stations are best used for processing bulk prescriptions. One bay of FAMA.M comfort drawers provides ideal storage for stationary, ultra-fast moving medicines and accessories.



Retail Storage

Using either single or double height drawers, the FAMA.M comfort system can be integrated beneath retail display units to provide the perfect storage space for bulk or excess stock. The location of stock enables easy re-stocking and keeps products clean and dust free.

Ultra Fast Movers



FAMA.M comfort drawers are ideal for storing ultra fast moving items when installed at either direct or traditional dispense stations. The drawer system's high quality mechanism allows for high frequency usage due to its steel fabrication and comfort features such as easy pull, comfort store, auto close and soft stop.

Stationery Drawer



Declutter your counter tops by storing your stationery in an easily accessible drawer and have everything at your fingertips when needed. Stationery drawers are typically fitted in addition to the standard drawer configuration and require counters with sufficient height clearance (50mm) to accommodate this. When retrofitting into existing FAMA.M comfort drawers the stationery drawer will be installed in place of a single height drawer.

Scripts On File



The double height FAMA.M comfort drawers are the perfect size to file repeat forms and can be transformed into an efficient and organised 'scripts on file' system. Choose between the combination of single and double height drawers based on your needs or simply re-position the double height drawer within the unit as required.

Scripts Ready



Adjoining bays of FAMA.M comfort are the ideal solution for ready scripts awaiting collection. Adopting the Willach alphanumeric storage system ensures optimal use of space not confined by the typical alphabetical organisation. The efficiency of this system delivers significant storage space benefits with a highly neat and professional presentation, maintaining optimum patient privacy and improving accuracy.

For a wide range of **scripts on file** and **scripts ready** accessories visit the Willach Online Shop. The shop for all your pharmacy needs – from products for dispensary operations and compounding to the latest in health devices – all conveniently in one place.

FAMA®.DAA drawers

The FAMA®.DAA is a specifically designed for storage of dose administration aids and is compatible with all blister brands. Similarly to the other FAMA® drawers, the DAA drawers are manufactured from powder coated steel with mesh bases, providing reliable and durable storage that requires no maintenance or cleaning.

The FAMA®.DAA drawer configuration is completely flexible and can be supplied as a standalone unit of single or multiple bays at custom height or integrated beneath a workbench space. In addition, the FAMA®.DAA drawers are compatible for use with FAMA®.M comfort drawer system and can be combined with components such as the single height or stationary drawers to produce the optimum DAA workstation.



The FAMA®.DAA storage unit is ideal for storing and organising dose administration aid blister packs and consumables.



The FAMA®.DAA drawers are also compatible with most blister brand storage trays or can be organised using the FAMA® dividers.



Flexible configuration options means the drawers can be built as a stand-alone unit, integrated beneath a workbench or combined with the FAMA®.M comfort system.

Each FAMA®.DAA drawer can comfortably store over 40 pre-packed blisters and is compatible with some blister brand storage trays or alternatively conveniently organised using the FAMA® divider range. The capacity and flexibility of the drawers also makes them an option for efficient and organised storage of DAA consumables.

The FAMA®.DAA drawers provide the most effective storage for DAA's, keeping patient blisters neatly organised, easy to find and undamaged. This greatly improves efficiency, minimises error and reduces costs—all in a compact space saving system.

FAMA®.DAA drawers

FAMA®.DAA storage drawers

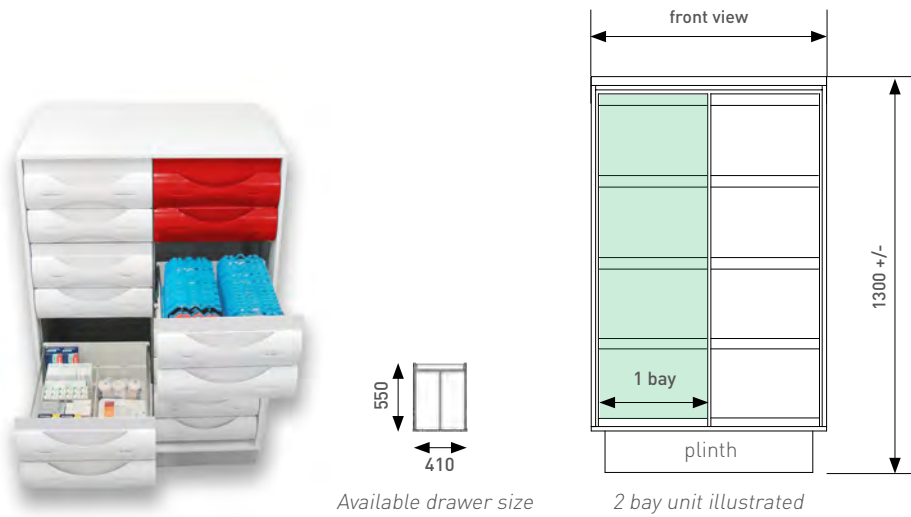

1 bay of FAMA®.DAA (Dose Administration Aid) storage drawers	
Custom configuration:	4 Double height drawers (300 mm high x 410 mm wide)
Storage capacity:	One double height drawer fits 42 blister packs; capacity depends on drawer configuration and use
Drawer unit depth:	600 mm (M550)
Overall width x height:	856 x 1261 mm (including 16 mm cladding, no plinth)

Note: Cladding is supplied by others unless agreed otherwise.

Configuration Options

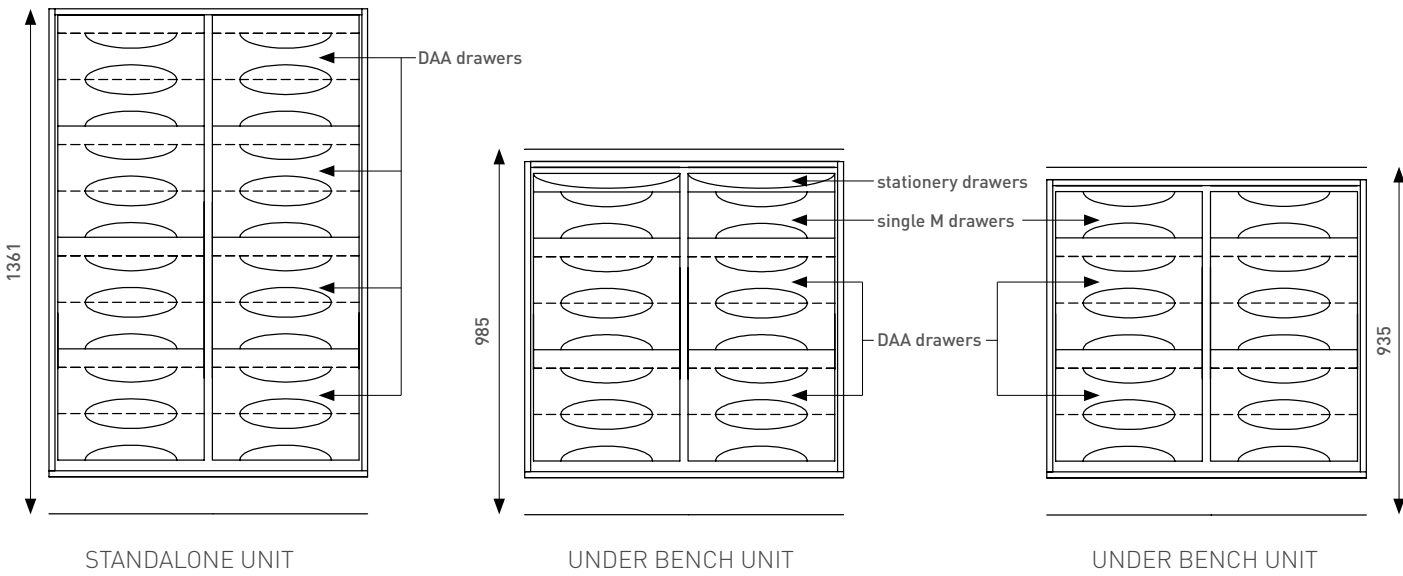

FAMA® components

FAMA® fast mover 300 component options:

- Flat shelf 300: slotted non-pull out shelf for use with steel dividers and plastic sub-dividers or a non-slotted smooth finish where dividers are not required. No label holder strip.
- Sloping tray 300: angled pull out tray, slotted for use with steel dividers and plastic sub-dividers. Includes label holder strip.
- Rooftop shelf 300: fixed flat top shelf. No label holder strip.

FAMA® fast mover 500 component options:

- Flat shelf 500: slotted non-pull out shelf for use with steel dividers and plastic sub-dividers or a non-slotted smooth finish where dividers are not required. No label holder strip.
- Sloping tray 500: angled pull out tray, slotted for use with steel dividers and plastic sub-dividers. Includes label holder strip.
- Flat tray 500: horizontal pull out tray, slotted for use with steel dividers and plastic sub-dividers. Includes label holder strip.
- Utility tray 500: horizontal pull out tray, smooth finish (non-slotted). No label holder strip.
- Rooftop shelf 500: fixed flat top shelf. No label holder strip.

FAMA® shelving system 600 component options:

- Sloping shelf 600: non-pull out angled shelf, slotted for use with steel dividers and plastic sub-dividers. Includes label holder strip.
- Flat shelf 600: non-pull out horizontal shelf, slotted for use with steel dividers and plastic sub-dividers. Includes label holder strip.
- Plastic boxes: various sizes available.
- Rooftop shelf 600: fixed flat top shelf. No label holder strip.

FAMA® worktop system component options:

- Above the workbench:*
- Flat shelf 300: slotted non-pull out shelf for use with steel dividers and plastic sub-dividers or a non-slotted smooth finish where dividers are not required. No label holder strip / Label holder strip included.
 - Sloping tray 300: angled pull out tray, slotted for use with steel dividers and plastic sub-dividers. Includes label holder strip.
 - Acrylic box rail: steel rail with 4 moveable acrylic boxes.
 - Worktop light: integrated light behind acrylic box rail for lighting up workbench area.
 - Top light: integrated light at top of unit for lighting upper shelves of unit.
 - Corner shelf 300: above bench shelf for corner shelf unit used for joining 2 worktop units around a corner.

Below the workbench:

- Flat shelf 500: slotted non-pull out shelf for use with steel dividers and plastic sub-dividers or a non-slotted smooth finish where dividers are not required. No label holder strip / Label holder strip included.
- Drawer 500: single height (125mm high) powder coated steel drawer with 1 fixed centre steel divider and 2 removable steel dividers. Additional plastic cross dividers, sub-dividers and various sized steel cross dividers give further compartmenting options. Label holder strip and individual label holders included.
- Drawer 500: double height (250mm high) powder coated steel drawer with 1 fixed centre steel divider and 2 removable steel dividers. Additional plastic cross dividers, sub-dividers and various sized steel cross dividers give further compartmenting options. Label holder strip and individual label holders included.
- Flat tray 500: horizontal pull out tray, slotted for use with steel dividers and plastic sub-dividers. Includes label holder strip.
- Utility tray 500: horizontal pull out tray, smooth finish (non-slotted). No label holder strip.
- Steel side panels: powder coated steel side panels available for standalone or end units where timber laminate cladding is not used.
- Corner shelf 500: below bench shelf for corner shelf unit used for joining 2 worktop units around a corner.

FAMA®.K drawer component options:

- Single height drawer: 125mm high powder coated steel drawer, powder coated steel mesh base and 1 fixed centre steel divider as standard (option for no centre divider available). Additional plastic cross dividers, sub-dividers and various sized steel cross dividers give further compartmenting options. Unit supplied with individual clear plastic label holders.
- Double height drawer: 250mm high coated steel drawer, powder coated steel mesh base and 1 fixed centre steel divider as standard (option for no centre divider available). Additional plastic cross dividers, sub-dividers and various sized steel cross dividers give further compartmenting options. Unit supplied with individual clear plastic label holders.
- Carriage step: integrated above the second drawer from the base of the unit. Weight bearing capacity of 150kg.
- Lock: an optional locking mechanism can be integrated into the drawers. The mechanism can lock a full height bay or easily adjusted to lock only certain drawers if required.

FAMA®.M comfort drawer component options:

- M comfort: single height (125mm high) 410mm wide powder coated steel drawer, powder coated steel mesh base and 1 central steel divider (removable). Additional plastic cross dividers, sub-dividers and various sized steel cross dividers give further compartmenting options. Unit supplied with individual clear plastic label holders.
- M comfort: double height (250mm high) coated steel drawer, powder coated steel mesh base and 1 central steel divider (removable). Additional plastic cross dividers, sub-dividers and various sized steel cross dividers give further compartmenting options. Unit supplied with individual clear plastic label holders.
- M3 comfort: single height (125mm high) 592.5mm wide drawer, with 2 longitudinal steel dividers (1 is removable).
- M3 comfort: double height (250mm high). All remaining specifications as per the M comfort drawer.
- M4 comfort: single height (125mm high) 775mm wide drawer, with 1 central fixed steel divider and 2 removable longitudinal steel dividers.
- M4 comfort: double height (250mm high). All remaining specifications as per the M comfort drawer.
- Stationary drawer: an optional stationary drawer can be integrated at the top of a FAMA®.M comfort drawer unit and is an ideal addition to a workstation configuration.
- Lock: an optional locking mechanism can be integrated into the drawers. The mechanism can lock a full height bay or easily adjusted to lock only certain drawers if required.

FAMA®.DAA drawer component options:

- DAA drawer: available as 300mm high and 550 deep drawer. Compatible with FAMA® plastic and steel dividers as well as clear individual label holders.
- Lock: an optional locking mechanism can be integrated into the drawers. The mechanism can lock a full height bay or easily adjusted to lock only certain drawers if required.

Willach Online Shop



Willach

Accessories for
Willach Products



Compounding



Health Devices



Dispensary Accessories



The online shop for pharmacies.

Easy and convenient access to all your pharmacy needs – from products for dispensary operations and compounding to the latest in health devices.

Join now and start shopping!



Fast. Compact. Efficient.

The state of the art CONSIS® robots are a highly compact automated dispensing system, providing optimum dispensing and storage efficiency as well as improved stock management.





Maximise the benefits from the key pharmacy resources: staff, stock and space

The cost-effective use of all resources is a key factor in the efficiency of your pharmacy. A CONSIS® automation solution from Willach creates the optimum conditions to achieve this goal. At Willach we understand each pharmacy is unique. That is why we undertake a thorough analysis of the dispensing process in your pharmacy to determine the optimal CONSIS® unit to suit your needs and allow your team to focus on delivering a superior customer experience.

The CONSIS® B robotic dispenser can be integrated into the workflow of your pharmacy seamlessly and without difficulty. The compact design takes up minimal space and delivers maximum flexibility and performance.



A range of options for individual needs

The CONSIS® B series offers a range of options to suit individual operational requirements. Factors such as dispensing type and volume will influence choice of unit and can be advised by Willach following a comprehensive analysis.



CONSIS® B0

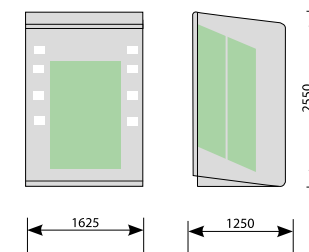

Storage capacity:
Up to 410 SKU's
Up to 3,300 packages
Footprint: 2 m²



CONSIS® B2

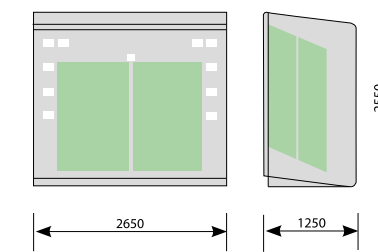

Storage capacity:
Up to 820 SKU's
Up to 6,600 packages
Footprint: 3.3 m²



CONSIS® B4

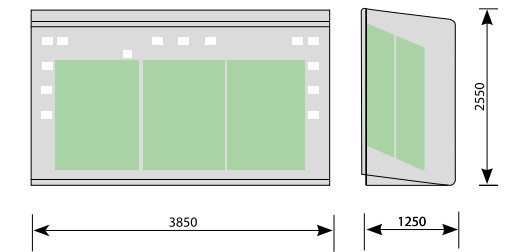

Storage capacity:
Up to 1230 SKU's
Up to 9,900 packages
Footprint: 4.8 m²

CONSIS® B1

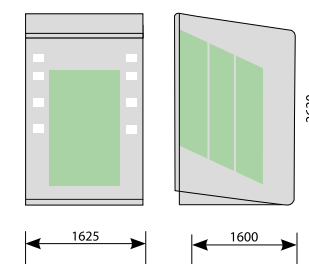

Storage capacity:
Up to 410 SKU's
Up to 4,900 packages
Footprint: 2.6 m²

CONSIS® B3

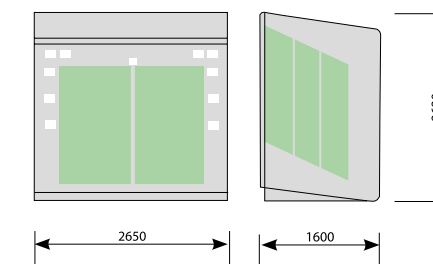

Storage capacity:
Up to 820 SKU's
Up to 9,800 packages
Footprint: 4.2 m²

CONSIS® B5

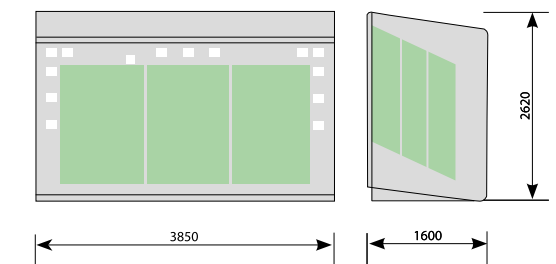

Storage capacity:
Up to 1230 SKU's
Up to 14,700 packages
Footprint: 6.2 m²

consis

The Australian Pharmacists' Choice in Automation

CONSIS® B—highly reliable system.

The CONSIS® technology is a proven and highly reliable system that has been on the Australian market since 2004. For further peace of mind, Willach has the largest network of qualified service technicians in Australia and operates a local customer support and service line 1800 95 55 22 — 7 days a week.

CONSIS B®—extremely fast, simple and accurate restocking.



The optical positioning system (OPS) restocking technology enables quick and accurate refilling of stock. Packages are filled into channels from the back and dispensed at the front, ensuring continual stock rotation and safe, accurate dispensing.

CONSIS B®—multiple exit points.

The extremely compact footprint allows for integration into the heart of the pharmacy operation without compromise to the overall workflow. Gravity fed chutes and perspex bins can cater for up to 8 surrounding workstations or conveyor systems can be added for more complex work areas if required.

CONSIS B®—handles bottles easily.

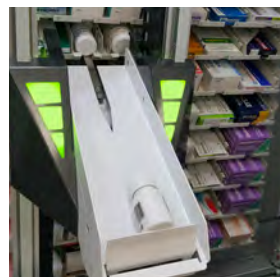

Medicine bottles are stored, dispensed and restocked quickly and easily without any need for double handling or specialised storage.

CONSIS® B—picks multiple packages at once.

Multiple packages of the same SKU can be picked and dispensed at once. This additionally saves valuable time.

CONSIS® B—easily integrated.

The compact footprint enables versatile integration into the smallest dispensary space. The variety of unit options makes the CONSIS® a flexible automated system that is suited to various dispensing environments.

CONSIS® B—simultaneous filling and dispensing.

The engineering of the CONSIS® allows for simultaneous filling and dispensing to occur without slowing down either process or affecting overall workflow.

CONSIS® B—easy to operate.



The user-friendly intuitive CONSIS® software is easy to use with the added convenience of the adjustable touch-screen monitor with integrated scanner and keyboard.

CONSIS® B—high speed picking.

Minimal travel distances of the picking mechanism enhance picking productivity. Where gravity chutes and perspex bins are used, each pack is delivered in 4-6 seconds to the workstation—halving the time required for manual picking.

CONSIS® B—works even if power fails.



Be it power failure or a computer crash, manually removing packages in an emergency is easy. Simply open the glass doors, remove the package—and you're done!





CASE STUDY: Slade Pharmacy

Camberwell, Melbourne, VIC

Size of pharmacy: 109 m²

Size of dispensary: 50 m²

FAMA® Solution: FAMA.K large capacity drawers and FAMA.MX under bench drawers for slow moving items; FAMA.MX under bench drawers for ultra fast moving items, scripts waiting to be collected and scheduled medication.

FAMA® Capacity: Approx. 10,000 packages with additional under bench storage dependent on configuration and use.

FAMA® Footprint: Approx. 5 m²

Start of operation: October 2013

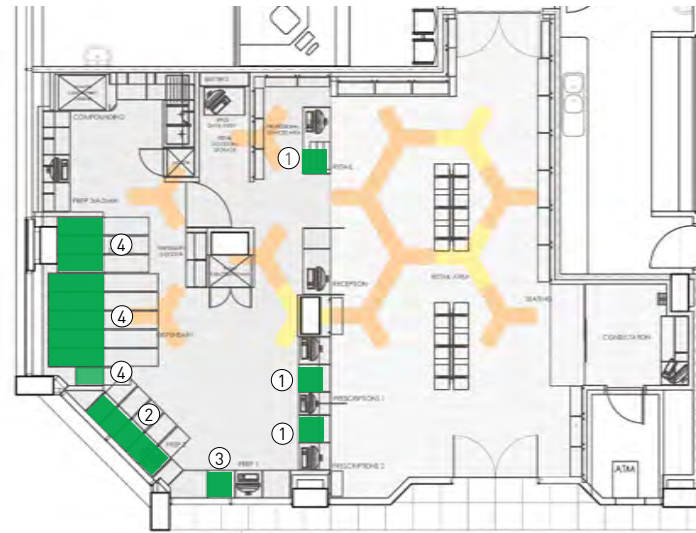

- ① ultra-fast moving items — stored in FAMA.MX (550) under bench drawers
- ② Prepared ward stock stored in the FAMA.MX under bench drawers
- ③ Scripts waiting to be collected by patients — stored in FAMA.MX under bench drawers
- ④ High capacity FAMA.K drawers for compact storage of remaining pharmacy stock

CASE STUDY: Apollo Pharmacy Joondalup

23-99 Joondalup Drive, Edgewater, WA, Australia

Approximate size of pharmacy: 118 m²

Approximate size of dispensary: 27 m²

FAMA® Solution: FAMA fast mover shelves, FAMA.K high capacity drawers, FAMA.MX under bench drawers.

FAMA® Capacity: Four bays of FAMA fast mover 500 up to 400 SKU's and 5,200 packages. Three bays of FAMA.K 1000 up to 900 SKU's and 4,500 packages. Four bays of FAMA.MX under bench drawers with storage dependent on configuration and use.

Willach Solution Footprint: 4 m²

Start of operation: March 2015

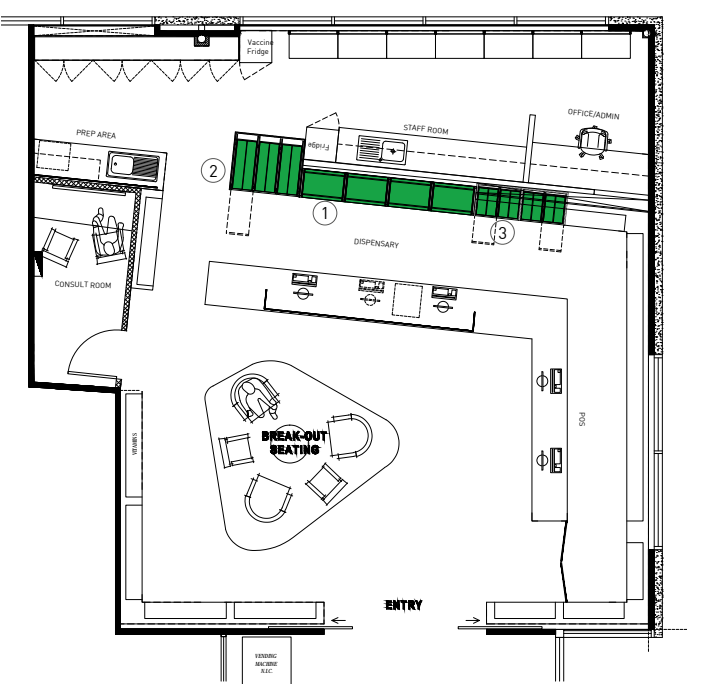

- ① Fast moving items – stored in the FAMA fast mover shelves
- ② Slow-moving items – stored in FAMA.K large capacity drawers
- ③ Scripts waiting to be collected by patients – stored in FAMA.MX under bench drawers

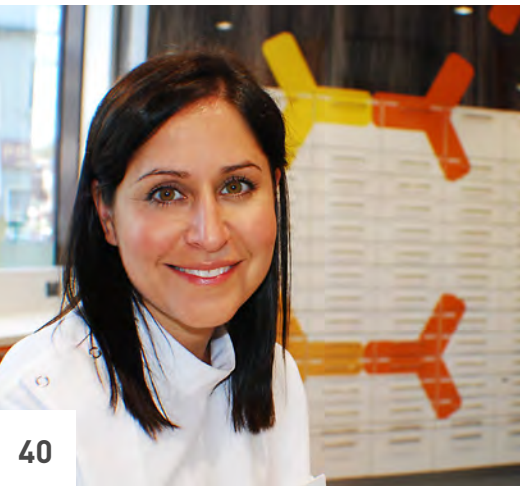

"We were lucky to start with a blank canvas at Camberwell Slade Pharmacy and wanted to create a truly unique and modern looking pharmacy with an efficient work environment suited to both the hospital and retail aspects of the business. A collaboration between acclaimed UK designer Keith Anderson and the team at Willach has produced a state of the art pharmacy that presents a quality health service image to our customers and allows us to operate very efficiently."

Romi Onas

Managing Pharmacist

Slade Pharmacy, 888 Toorak Road, Camberwell, VIC, Australia



"When I think of modern German companies I instantly relate to BMW, Allianz, Siemens, Bayer and Continental to name a few. Powerhouse progressive companies all on the cutting edge in their fields of endeavour. Highly efficient corporations that pride themselves on quality and precision. In my experience Willach fits in with these industry leaders perfectly. When we designed Apollo Pharmacy Joondalup we wanted a super modern and professional look that matched the equally structured Urgent Care Medical Centre it was attached to. First impressions are vital and as soon as you venture into Apollo Joondalup we wanted the patient to know they were entering a professional and structured pharmacy. By combining Willach's FAMA.K drawer systems and FAMA fast mover shelving system we achieved the perfect look combined with superior functionality you would expect in say a Mercedes Benz. So impressive is the quality of every aspect of the Willach system my children begged me to have the drawers and hidden steps installed in our home. In my experience the Willach systems are easily the market leader in dispensary design and I will not hesitate in using them in future projects."

David J Tomazin

Bpharm MPS

Proprietor

23-99 Joondalup Drive, Edgewater, WA, Australia



CASE STUDY: Community Care Chemist Belmont

157 High Street, Belmont, VIC, Australia

Approximate size of pharmacy: 580 m²

Approximate size of dispensary: 70 m²

CONSIS® Solution: CONSIS B1 robotic dispenser, FAMA.K large capacity drawers for slow moving items.

CONSIS® Capacity: Up to 412 SKU's and up to 5600 packages.

FAMA® Capacity: Three bays of FAMA.K 1200 up to 6,000 packages, dependent on configuration and use. FAMA.MX under bench drawers for ultra fast moving items, scripts waiting to be collected and scheduled medication and FAMA worktop system with overhead sloping shelves and underbench pull out trays for webster preparation.

Willach Solution Footprint: Less than 6 m²

Start of operation: September 2013

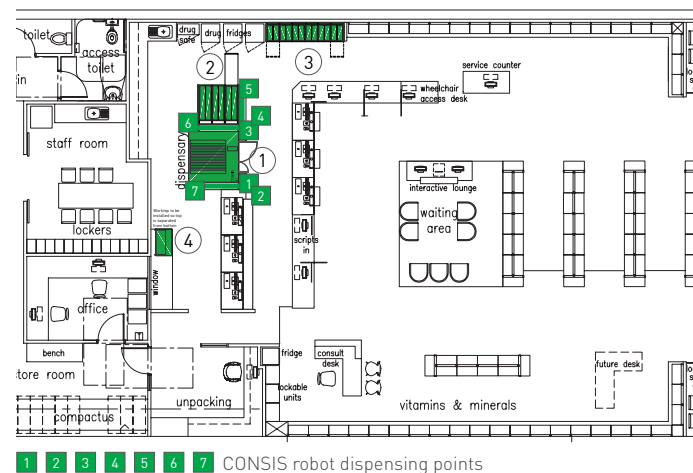
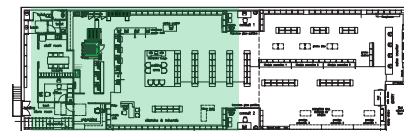

1 2 3 4 5 6 7 CONSIS robot dispensing points

- ① Fast moving items — stored in the CONSIS B1 robot
- ② Slow-moving items — stored in FAMA.K large capacity drawers
- ③ Scripts waiting — stored in FAMA.MX under bench drawers
- ④ DAA preparation items — stored in FAMA worktop system

CASE STUDY: Crisp's Healthy Living Pharmacy

Corner Wairakei Road & Greers Road,
Christchurch, New Zealand

Approximate size of pharmacy: 287 m²

Approximate size of dispensary: 61 m²

FAMA® Solution: FAMA round shelf 1800, FAMA.MX under bench drawers and FAMA worktop system for storage of fast and slow moving items, scripts waiting to be collected, scheduled medication and other pharmaceutical items.

FAMA® Capacity: Approx. 6,500 packages with additional over head and under bench storage dependent on configuration and use.

FAMA® Footprint: Approx. 6 m²

Start of operation: December 2013

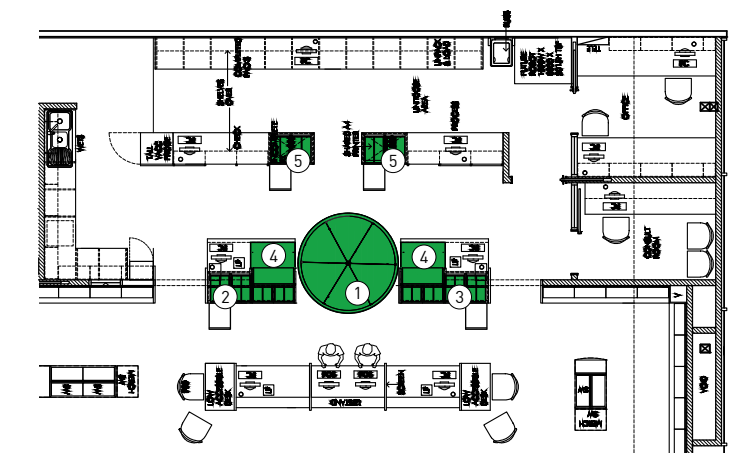
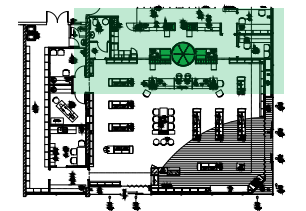

- ① Top 60 fast moving items and more than 500 slow moving items — stored in FAMA round shelf 1800
- ② Scheduled medication storage in the FAMA.MX under bench drawers
- ③ Scripts waiting to be collected by patients — stored in FAMA.MX under bench drawers
- ④ FAMA worktop system for storage of top 30 fast moving items
- ⑤ Pharmaceutical items such as injectables and eye drops stored in the FAMA.MX under bench drawers



"Our management team identified we needed to overhaul our pharmacy operation to remain viable for the long term. Willach was able to offer the expertise, support and service to achieve our goals; from consultation through to design and implementation. The result has streamlined our workflow making our staff much more efficient and most importantly allowing the pharmacists more time with our customers. Our Willach dispensary now meets the demands of our business today and safeguards our future."

Julie Ryan

CEO Community Care Chemists

Community Care Chemist Belmont, 157 High Street, Belmont, VIC, Australia



"When I heard about Willach, I knew their customer focused strategies were an ideal fit for the pharmacy with the changing environment in the profession. We underwent the redevelopment within a tight time frame, right before Christmas, and Willach was absolutely fantastic guiding us through the process. Since installing their FAMA round shelf solution, I have noticed a positive change in the culture of Crisp's Healthy Living Pharmacy and marked improvement in stock management. The dispensing process is also much faster, freeing up time for our pharmacists to spend up front advising patients about their healthcare. Our customers have really noticed a difference and we're attracting more and more foot traffic. They're impressed by the fact that we're embracing new and exciting technology, and love that contact with a pharmacist is so accessible. I really support the direction the profession is heading, so when I see my pharmacists sitting and engaging with patients, doing what they do best, it's a great feeling."

Karen Crisp

Managing Pharmacist

Crisp's Healthy Living Pharmacy, Corner Wairakei Road & Greers Road, Christchurch, New Zealand



CASE STUDY: Priceline Pharmacy — World Square

644 George St, Sydney, NSW, Australia

Size of pharmacy: 815 m²

Size of dispensary: 50 m²

CONSIS® Solution: CONSIS B1 robotic dispenser, FAMA.K large capacity drawers for slow moving items, FAMA.MX under bench drawers for ultra fast moving items, scripts waiting to be collected and scheduled medication and FAMA worktop system with overhead sloping shelves and underbench pull out trays for webster preparation.

CONSIS® Capacity: Stores up to 412 SKU's and up to 5,600 packages.

FAMA® Capacity: Three bays of FAMA.K 1200 up to 1200 SKU's and 6,000 packages. Five FAMA.MX under bench drawers and 1 FAMA worktop system capacity dependent on configuration and use.

Willach solution footprint: Less than 6 m²

Start of operation: August 2012

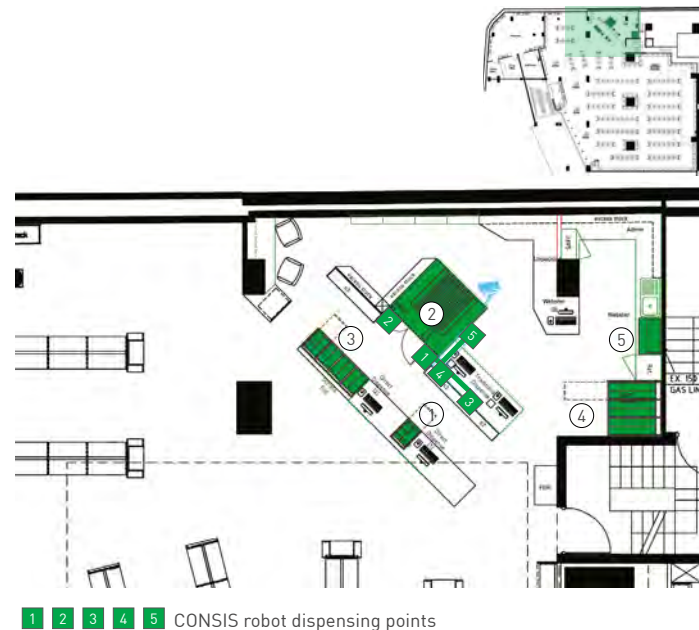

1 2 3 4 5 CONSIS robot dispensing points

- ① Ultra-fast moving items — stored in FAMA.MX under bench drawers
- ② Fast moving items — stored in the CONSIS B1 robot (more than 80% of daily dispensed items)
- ③ Scripts waiting to be collected by patients — stored in FAMA.MX under bench drawers
- ④ Slow-moving items — stored in FAMA.K large capacity drawers
- ⑤ DAA and extemporaneous preparation items — stored in FAMA worktop system

CASE STUDY: Priceline Pharmacy – Forster

Forster Village Shopping Centre, Breese Pde, Forster, NSW, Australia

Size of pharmacy: 440 m²

Size of dispensary: 58 m²

CONSIS® solution: CONSIS B3 robotic dispenser for fast moving items, FAMA.K high capacity drawers for slow moving items, FAMA.MX drawers with custom height configuration for scripts waiting to be collected, staged supply and miscellaneous additional storage.

CONSIS® capacity: stores up to 820 SKU's and up to 9,800 packages.

FAMA® capacity: Three bays of FAMA.K 1000 drawers for storage of up to 900 SKU's and 4,500 packages. Eight bays of FAMA.MX drawers with custom configuration—variable storage capacity dependent on application.

Willach solution footprint: 7.5m²

Start of operation: October 2014

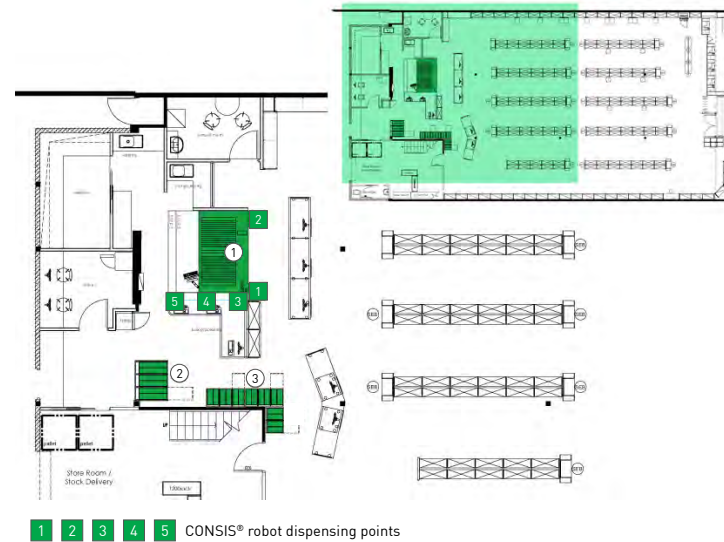

1 2 3 4 5 CONSIS® robot dispensing points

- ① Fast moving items – stored in CONSIS B3 (> 80% of daily dispensing and > 1 week stock holding)
- ② Slow moving items – stored in FAMA.K large capacity drawers
- ③ Scripts waiting to be collected by patients – stored in custom configured FAMA.MX drawers.



"I have found Willach both very professional and understanding to deal with. It was 3 years since I initially talked to them to when we installed the CONSIS. They were patient and listened to my needs throughout the process. Willach worked with me though numerous concepts until we got the dispensary concept and workflow we were happy with. The support provided during installation and initial training was 1st class. The post installation support and maintenance as well as training is and remains excellent. The pharmacist and dispensary team tells me having the CONSIS is like having "an additional pharmacist" working at the dispensary. The work load and dispensing process feels a lot easier; enabling the pharmacist to place greater focus at what they are really there for; patient focus and customer care."

Alex Wee

Pharmacist and Partner

World Square Priceline Pharmacy, 644 George St, Sydney, NSW, Australia



"In working with Willach we have changed our dispensary from what was a very old and traditional set up to a much more modern and technologically advanced operation. This change has enabled us to free up a lot of our pharmacists time. Having the professional staff interacting more with our patients then allows us to more readily identify additional opportunities such as clinical interventions—and we have found that this has lifted our script volumes and grown our financial results. It's a great time to be in pharmacy and see the profession move from a product supplier to a service provider role and I feel the changes we have made have really put us on the front foot to maximise our share of the 6CPA funding."

Gavin Hodges

Pharmacist and Proprietor

Forster Priceline Pharmacy, Forster Village Shopping Centre, Breese Pde, Forster, NSW, Australia



CASE STUDY: Terry White Chemists — Gasworks

Shop A3, 76 Skyring Tce, Newstead, QLD, Australia

Approximate size of pharmacy: 294 m²

Approximate size of dispensary: 32 m²

FAMA® Solution: FAMA fast mover shelves, FAMA.MX under bench drawers.

FAMA® Capacity: Three bays of FAMA fast mover shelves storing up to 1,300 packages and FAMA.MX under bench drawers covering 20 linear metres of storage.

Willach solution footprint: Less than 2 m²

Start of operation: August 2013

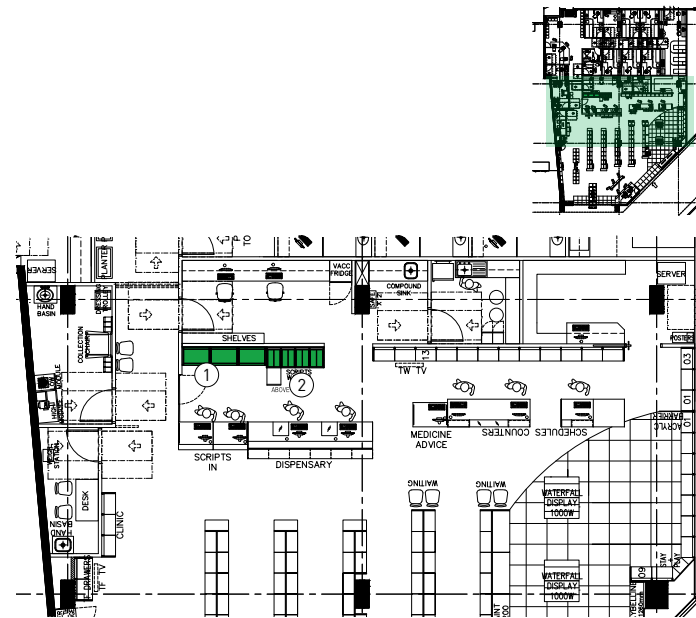

- ① Fast moving items – stored in the FAMA fast mover shelves
- ② Slow moving items – stored in FAMA.MX under bench drawers

CASE STUDY: Terry White Chemists — Knox City

Shop 1060, Westfield Knox Shopping Centre
425 Burwood Hwy, Wantirna South, VIC, Australia

Approximate size of pharmacy: 847 m²

Approximate size of dispensary: 55 m²

CONSIS® Solution: CONSIS B2 robotic dispenser for fast moving items and FAMA.K large capacity drawers for slow moving items.

CONSIS® Capacity: Stores up to 824 SKU's and up to 7,520 packages.

FAMA® Capacity: Four bays of FAMA.K 1200 up to 8,000 packages, dependent on configuration and use. FAMA.MX under bench drawers for ultra-fast moving items and scheduled medication, storage capacity dependent on configuration and use.

Willach solution footprint: Less than 7 m²

Start of operation: March 2014

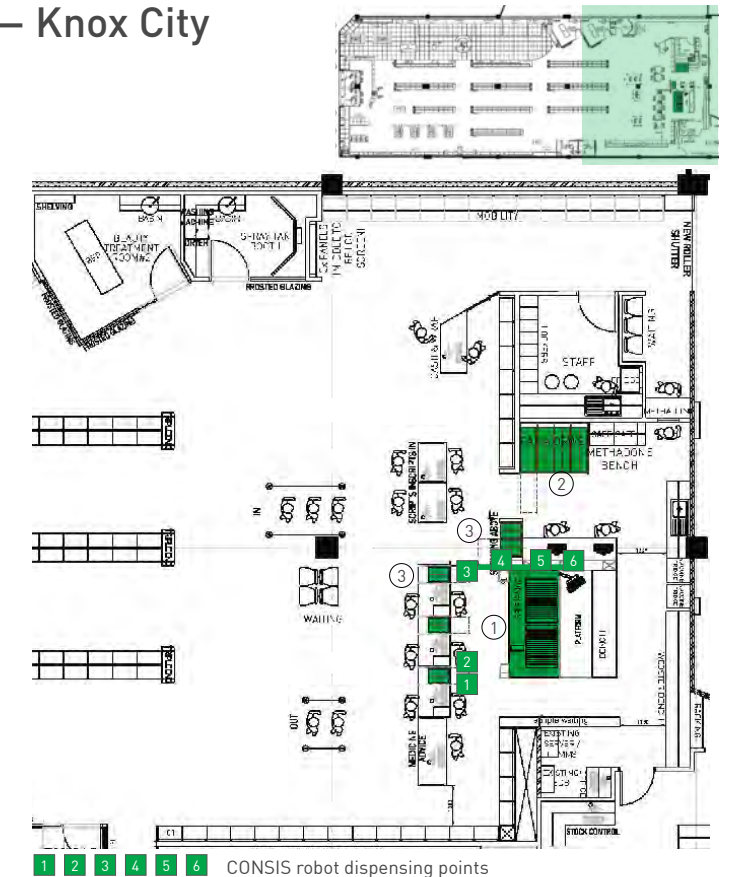

- ① Fast moving items — stored in the CONSIS B2 robot
- ② Slow moving items — stored in FAMA.K large capacity drawers
- ③ Ultra-fast moving and S3 items – stored in FAMA.MX under bench drawers



"When we were designing our new pharmacy, I knew we needed to have a point of difference that our time poor customer would appreciate, while still enabling our pharmacists to offer good service and health solutions that the customer needed. The only way we would achieve this was by direct dispensing. Willach helped us with a design that enabled us to do this efficiently, economically and still allowing us room to grow over time. The customers are happy as they are getting what they came in for — good quality advice, efficient dispensing and solutions for their health concerns all from the one pharmacist. My pharmacists are happy as they are fulfilling their professional goals and utilising their skills and knowledge that they have worked so hard to get, and what could be more satisfying than that?"

Sijetlana Conn

Pharmacy Director and Pharmacist

Terry White Chemists Gasworks, Shop A3, 76 Skyring Tce, Newstead, QLD, Australia



"We had partnered with Willach in the past to create a forward dispensing pharmacy, which we have found to be very successful in improving our efficiencies, increasing our pharmacists interaction with customers and ultimately growing FOS sales. In rebranding the iconic Knox pharmacy back to its roots as a TWC, we once again employed the expertise of Willach to create a dispensary that would complement the TWC health focused direction and provide our customers with the best possible experience. The results speak for themselves, customer feedback has been very positive and we have now engaged Willach in a further 2 pharmacy projects later this year."

Tony Le

Pharmacist and Partner

Terry White Chemists Knox, Shop 1060, Westfield Knox Shopping Centre
425 Burwood Hwy, Wantirna South, VIC, Australia



CASE STUDY: Rowville Chemmart Pharmacy

2/1100 Wellington Rd, Rowville, VIC

Approximate size of pharmacy: 202 m²

Approximate size of dispensary: 36 m²

FAMA® Solution: FAMA round shelf 1800 for fast moving items, FAMA.K large capacity drawers for slow moving items.

FAMA® Capacity: FAMA round shelf 1800 up to 500 SKU's and up to 6,000 packages. FAMA.K up to 6,000 packages, dependent on configuration and use. FAMA.MX under bench drawers for ultra fast moving items, scheduled medication and scripts on file/awaiting collection.

Willach Solution Footprint: Less than 7 m²

Start of operation: July 2015

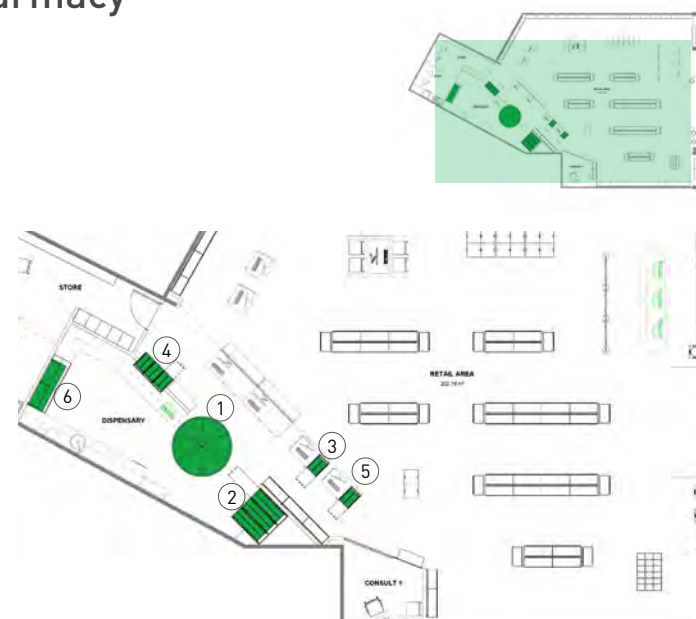

- ① Fast moving items – stored in the FAMA round shelf 1800
- ② Slow moving items – stored in FAMA.K large capacity drawers
- ③ Ultra-fast moving and S3 items – stored in FAMA.MX under bench drawers
- ④ Completed scripts awaiting collection – stored in FAMA.MX under bench drawers
- ⑤ Scripts on file – stored in FAMA.MX under bench drawers
- ⑥ DAA and extemporaneous preparation items — stored in FAMA worktop system

CASE STUDY: Peter Smith Chemmart Pharmacy

180 Summer Street, Orange, NSW

Approximate size of pharmacy: 220 m²

Approximate size of dispensary: 36 m²

CONSIS® Solution: CONSIS B0 robotic dispenser for fast moving items, FAMA.K large capacity drawers for slow moving items.

CONSIS® Capacity: Up to 410 SKU's and up to 3,760 packages.

FAMA® Capacity: Three bays of FAMA.K 1000 up to 4,500 packages, dependent on configuration and use. FAMA.MX under bench drawers for ultra fast moving items, scheduled medication and scripts on file/awaiting collection.

Willach Solution Footprint: Less than 7 m²

Start of operation: March 2015



1 2 3 4 5 CONSIS robot dispensing points

- ① Fast moving items – stored in the CONSIS B0 robot
- ② Slow moving items – stored in FAMA.K large capacity drawers
- ③ Ultra-fast moving and S3 items – stored in FAMA.MX under bench drawers
- ④ Completed scripts awaiting collection – stored in FAMA.MX under bench drawers
- ⑤ Scripts on file – stored in FAMA.MX under bench drawers
- ⑥ DAA and extemporaneous preparation items — stored in FAMA worktop system



"Once we became accustomed to the new set up, the FAMA round shelf (which we have fondly nicknamed "the wheel of fortune") not only created more room in the dispensary but also allowed us to dispense more efficiently. The innovative team at Willach have created a system that significantly increased the visibility of the pharmacist and does not allow for dispensary inefficiencies. As a result, the work flow has become more streamlined and with the correct staffing ratio, pharmacists are now more available to address the patients' healthcare needs. It has only been a few months since the new design has been implemented, but we are confident that these changes will lead to enhanced patient care and an improved customer experience, thus bringing us another step closer to our vision of a holistic, service-based pharmacy."

Wern Li Chia
Managing Pharmacist

Rowville Chemmart Pharmacy, 2/1100 Wellington Rd, Rowville, VIC



"As a long term and now repeat customer, the decision to once again work with Willach on an upgrade was an easy one given our experience with their support and service over the years. The longevity of our existing CONSIS unit meant it was a perfect fit for our second lower volume store, whilst a second new model CONSIS was installed at our larger Chemmart store. Willach again provided all their expertise with design and training and their install team had both stores up and running with a CONSIS within a week. The Willach systems and design are a perfect fit with our Chemmart branding and I would like to share this great experience with other Chemmart members so that they know how well this can work for them also. The amount of time and space saving and overall efficiency we have gained has been tremendous and brought significant benefits to our operation."

Kate Gray
Proprietor

Peter Smith Chemmart Pharmacy, 180 Summer Street, Orange, NSW

Willach Pharmacy Solutions.

The Australian Pharmacists' choice.



Willach is the market leader in Australia and Europe with regard to professional storage and dispensing equipment for medicines. With FAMA® and CONSYS®, Willach can provide system solutions for the conventional and fully automated storage of medicine packages: for any type of pharmacy, for any size of pharmacy. Willach undertakes all product development and production in Germany to assure the highest quality standards.



consis robotic systems

CONSYS® robotic systems offer a tailor-made and highly efficient automation concept for your pharmacy. Whether you want to save time or gain space: CONSYS® has the right solution for every situation.

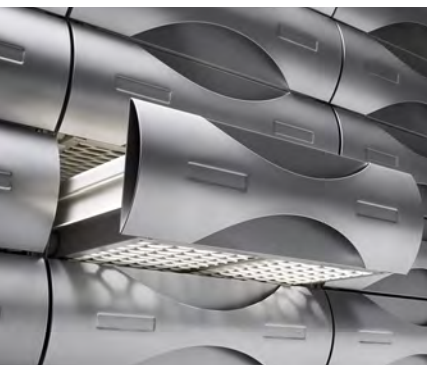

FAMA drawer systems

FAMA® large-capacity and underbench drawers provide fast access to packages, with good visibility, excellent space utilisation and ergonomically perfect operation. No other system offers you drawers which can store more packages in the same space.



FAMA shelving systems

FAMA® worktop system and fast mover shelves were developed as a modular system to achieve the greatest possible flexibility. They can be precisely adapted to your individual requirements. FAMA® round shelves store fast moving items to provide easy and direct access to stock from any angle.



John Koot 0409 096 734
Managing Director

Jan Pendrakowski 0418 385 788
Regional Sales Manager - VIC/TAS

Simon Gerrits 0428 828 868
Regional Sales Manager - WA/SA

Bernard Steele 0498 106 750
Regional Sales Manager - QLD/NT

Colin Potts 0413 647 781
Regional Sales Manager - NSW/ACT

Simon Skruzny 0421 510 527
Territory Manager - WA

Willach Australia Pty Ltd

**Building 11, 15-21 Huntingdale Road
Burwood, Victoria, 3125
Australia
Phone 03 9429 8222
Fax 03 9429 8233
info@willach.com.au
www.willach.com.au**



www.linkedin.com/company/willach-australia/

German Head Office:

**Willach Pharmacy Solutions GmbH
Stein 2
53809 Ruppichteroth
Germany
Phone +49 (0) 2295 9208 0
Fax +49 (0) 2295 9208 499
info@willach.com
www.willach.com**

WillachGroup